

Are you running Out of Space?

We Can Help!



Car collectors, enthusiasts, and small race teams find Fordham Park an excellent location to store and service their vehicles.

FORDHAM PARK 658 Griffith Road in Charlotte



On site repair shop, Automotive Excellence, specializes in High Performance, Luxury, and Vintage vehicles including restoration, race car preparation and set up. Your one stop shop for Porsche, Ferrari, and other fine automobiles.

LOCATION HIGHLIGHTS

- Convenient South Charlotte Location
- Located off 77 & Tyvola Rd, behind Costco
- Convenient access to interstates 77, 485, & 85
- Minutes to Uptown Charlotte and Airport
- Near retail stores, restaurants and hotels
- Walking distance to light rail line



BUILDING FEATURES

- Units range in size from 1,260 to 2,520 sq ft
- 50' bay depth
- I-2 Zoning
- Sealed floors
- 18' interior warehouse clear height allows use of vehicle lifts for increased storage capacity and servicing of vehicles.
- Oversized 12' x 14' garage door provides accessibility for the largest car haulers and trailers.
- Carpeted office with A/C & Heat, pre-wired telephone and Time Warner cable.
- ADA accessible restroom in each unit.
- ESFR High Output Sprinkler System.

FORD
REALTY COMPANY INC.

For information contact: Gail Roop or Andy Burch (704) 332-1000
FORD REALTY COMPANY, INC., 628 Griffith Road, Charlotte, NC 28217
groop@fordrealtync.com * aburch@fordrealtync.com * www.fordrealtync.com

Space Plan

Fordham Park

1,260 SF Total

146 SF Office

1,114 SF Warehouse

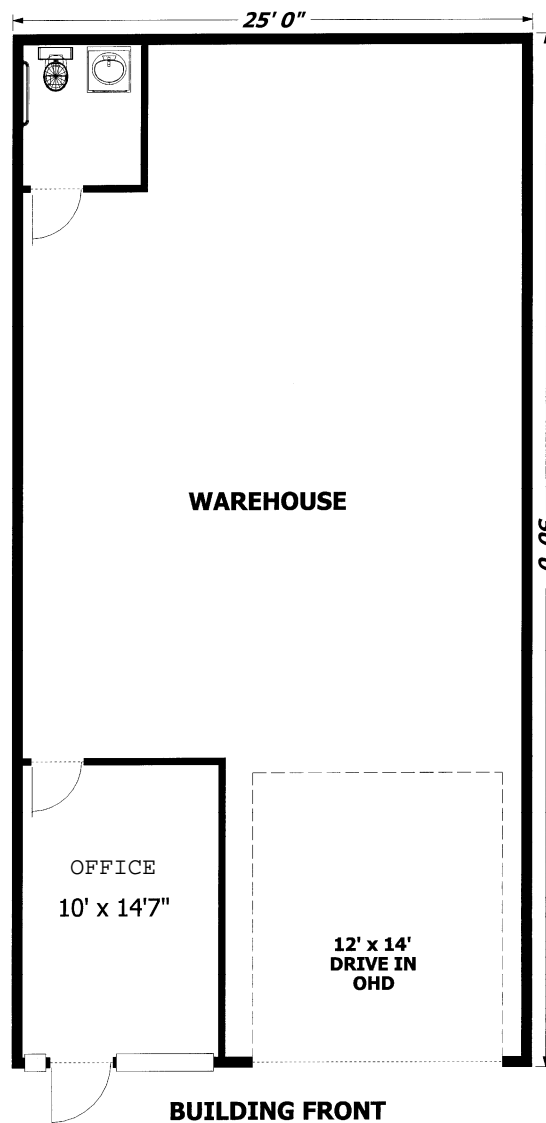

For more information, call 704/332-1000